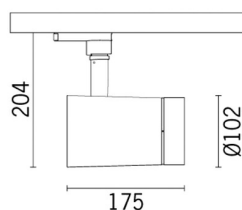

Last information update: October 2024

**Product configuration: P205**

P205: small body - Neutral White - dimmable electronics - flood optic

**Product code**

P205: small body - Neutral White - dimmable electronics - flood optic

**Technical description**

Adjustable spotlight with adapter for installation on mains voltage track for high-performance LED with monochromatic Neutral White (4,000K) emission. Dimmable electronic ballast built-into product. The fitting is made of die-cast aluminium and thermoplastic material. It enables 360° rotation around the vertical axis and 90° inclination with respect to the horizontal plane. It is provided with mechanical locks for orientation, for both rotations, which are applied by using the same tool on two screws, one in lateral position to the rod and one on the track adapter. Passive cooling system. Spotlight able to house up to two flat accessories at the same time. One further external component can be applied, either directional flaps or anti-glare screen. All the external accessories can be rotated by 360° with respect to the longitudinal axis of the spotlight.

**Installation**

Mounted on electrified track on dedicated base

**Colour**

White (01) | Black (04)

**Weight (Kg)**

1.28

**Mounting**

three circuit track

**Wiring**

Dimmable electronics components contained within the fitting

Complies with EN60598-1 and pertinent regulations

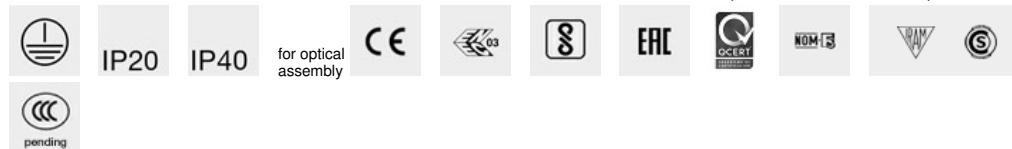
**Technical data**

Im system:	2277	Life Time LED 1:	> 50,000h - L90 - B10 (Ta 25°C)
W system:	27.5	Lamp code:	LED
Im source:	3200	Number of lamps for optical assembly:	1
W source:	24	ZVEI Code:	LED
Luminous efficiency (Im/W, real value):	82.8	Number of optical assemblies:	1
Im in emergency mode:	-	Power factor:	See installation instructions
Total light flux at or above an angle of 90° [Lm]:	0	Inrush current:	5 A / 50 µs
Light Output Ratio (L.O.R.) [%]:	71	Maximum number of luminaires of this type per miniature circuit breaker:	B10A: 31 luminaires B16A: 50 luminaires C10A: 52 luminaires C16A: 85 luminaires
Beam angle [°]:	38°	Minimum dimming %:	1
CRI (minimum):	80	Overvoltage protection:	4kV Common mode & 2kV Differential mode
Colour temperature [K]:	4000	Control:	Completo di dimmer
MacAdam Step:	2		

**Polar**

Imax=6335 cd		Lux			
90°	180°	90°	h	d	Em Emax
			2	1.3	1323 1544
			4	2.7	331 386
			6	4	147 172
			8	5.4	83 97
α = 37°					

### Isolux

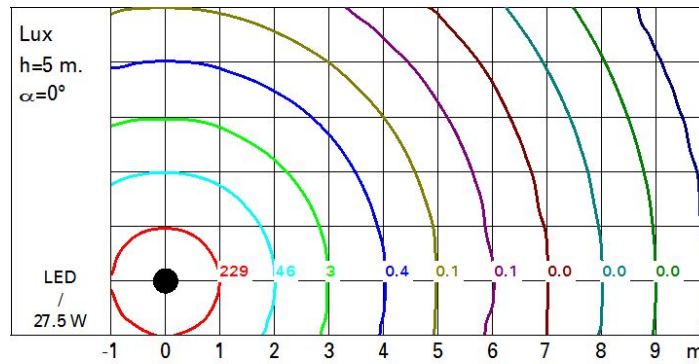

### UGR diagram

Corrected UGR values (at 3200 lm bare lamp luminous flux)											
Reflect.:		viewed crosswise					viewed endwise				
ceiling		0.70	0.70	0.50	0.50	0.30	0.70	0.70	0.50	0.50	0.30
walls		0.50	0.30	0.50	0.30	0.30	0.50	0.30	0.50	0.30	0.30
work pl.		0.20	0.20	0.20	0.20	0.20	0.20	0.20	0.20	0.20	0.20
Room dim		viewed crosswise					viewed endwise				
x	y										
2H	2H	1.8	2.3	2.0	2.5	2.7	1.8	2.3	2.0	2.5	2.7
	3H	1.7	2.1	2.0	2.4	2.6	1.7	2.1	2.0	2.4	2.7
	4H	1.6	2.0	1.9	2.3	2.6	1.6	2.0	1.9	2.3	2.6
	6H	1.5	1.9	1.9	2.2	2.5	1.5	1.9	1.9	2.2	2.6
	8H	1.5	1.9	1.8	2.2	2.5	1.5	1.9	1.9	2.2	2.5
	12H	1.4	1.8	1.8	2.1	2.5	1.5	1.8	1.8	2.2	2.5
4H	2H	1.6	2.0	1.9	2.3	2.6	1.6	2.0	1.9	2.3	2.6
	3H	1.5	1.8	1.8	2.2	2.5	1.5	1.8	1.8	2.2	2.5
	4H	1.4	1.7	1.8	2.1	2.5	1.4	1.7	1.8	2.1	2.5
	6H	1.3	1.6	1.7	2.0	2.4	1.3	1.6	1.7	2.0	2.4
	8H	1.3	1.5	1.7	1.9	2.4	1.3	1.5	1.7	1.9	2.4
	12H	1.2	1.4	1.7	1.9	2.3	1.2	1.4	1.7	1.9	2.3
8H	4H	1.3	1.5	1.7	1.9	2.4	1.3	1.5	1.7	1.9	2.4
	6H	1.2	1.4	1.6	1.8	2.3	1.2	1.4	1.6	1.8	2.3
	8H	1.1	1.3	1.6	1.8	2.3	1.1	1.3	1.6	1.8	2.3
	12H	1.1	1.2	1.6	1.7	2.2	1.1	1.2	1.6	1.7	2.2
12H	4H	1.2	1.4	1.7	1.9	2.3	1.2	1.4	1.7	1.9	2.3
	6H	1.1	1.3	1.6	1.8	2.3	1.1	1.3	1.6	1.8	2.3
	8H	1.1	1.2	1.6	1.7	2.2	1.1	1.2	1.6	1.7	2.2
Variations with the observer position at spacing:											
S =		1.0H	5.1 / -6.9				5.1 / -6.9				
		1.5H	7.9 / -10.4				7.9 / -10.4				
		2.0H	9.8 / -17.0				9.8 / -17.0				