



Laser blade original is a collection of recessed downlights for architectural applications. The luminaires are equipped with high performance Opti Beam optics system for low luminance downlights (UGR < 10). Laser blade original is available in 5 aperture sizes, trim or trimless, 5 distributions, generous outputs of up to 2583 lumens and excellent chromatic performance .

NOW ASSEMBLED IN NORTH AMERICA.

Luminaire characteristic:

Power input: 12.6W or 24.7W (system wattage)
Lumens: 851lm to 1661lm (for 3000K, 92CRI)
Luminaire efficacy: 67lm/W

Source:	White LED module (LM-80) 3000K: 92CRI (90CRI min), 3500K: 92CRI (90CRI min), 4000K: 92CRI (90CRI min).
Lumen maintenance:	90% of initial lumens at 50 000 hours (L90) (LM-79).
Optics:	Low luminance: Flood and wide flood optics with Opti Beam technology.
Material:	Body and heat sink: Die-cast aluminum Reflector and baffle: Thermoplastic Housing: Galvanized steel
Mounting:	New construction housing suitable for insulated ceiling.
Electrical:	High efficiency LED driver ratings: ILB02: 50 000 hours with insulation.
Dimming:	0-10V dimming (120-277V), down to 15%.
Finish:	Black or white (RAL9010).
Weight:	0.20lbs (0.09kg)
Warranty:	5 year limited warranty.
Ratings:	IP20, IP23 (from under the ceiling)

Certification:



cULus listed for damp location. Interior use only.

Energy star certified product (except ILB01/ILB02).
 To confirm which versions are certified, please consult the product list: www.energystar.gov/productfinder

Assembled in North America.

Quick ship:

Lead time is 10 working days from written receipt of order. For orders that exceed the maximum quantity (100), please contact our Customer Service for approval. We will do our best to accommodate your needs. All orders received after 3pm EST will be processed the next business day. Standard shipping terms apply.



ORDERING INFO

ILB 02 - TR - IC - - FL - UNV - - D10
FIXTURE

BI - LB 02 TR - IC
HOUSING

MODEL

☒ **02** - Two

MOUNTING

☒ **TR** - Trim

INSTALLATION TYPE

☒ **IC** - New construction insulated ceiling

LED

☐ **030** - 3000K, 92CRI⁽¹⁾ ☐ **035** - 3500K, 92CRI⁽¹⁾ ☐ **040** - 4000K, 92CRI⁽¹⁾

OPTIC

☒ **FL** - Flood 32°

VOLTAGE

☒ **UNV** - 120-277V

FINISH (trim finish / baffle finish*)

	White trim	Black trim
<input checked="" type="checkbox"/> Black baffle	<input type="checkbox"/> 01 - White/Black	<input type="checkbox"/> 02 - Black/Black
<input checked="" type="checkbox"/> White baffle	<input type="checkbox"/> 31 - White/White	

DIMMING*

☒ **D10** - 0-10V

⁽¹⁾ 92CRI typical - 90CRI minimum.

* The dimming levels will vary depending on the dimmer used and the number of luminaires on the line.



INSTALLATION OPTIONS

New construction with housing suitable
for insulated ceiling (IC)

Housing with hanger bars system for new construction installations.
Suitable for insulated ceiling applications.
Housing can be shipped separately.

Ceiling thickness:
Trim: 1/8" - 1 1/8" (3mm - 29mm)

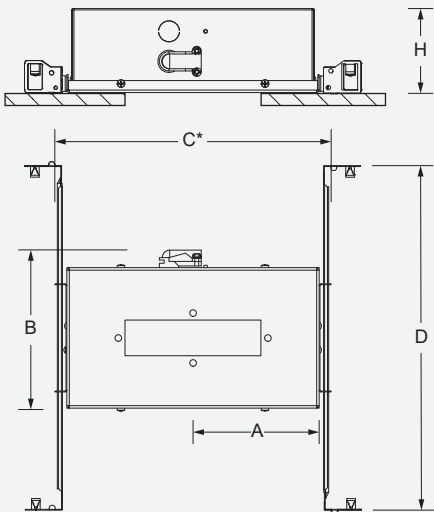

*Provide a minimum of 1 1/8" (46mm) on each side for the hanger bar fixations

Model	Housing	Cut-out dimensions	Cut-out position (A)	Overall dimensions (BxC)	Hanger bars (D)	Clearance (H)
ILB02	BI-LB02TR-IC	1 3/8" x 2 1/2" (35 x 64mm)	6 5/16" (160mm)	6 5/16" x 11 1/2" (167mm x 292mm)	14 1/4" to 26" (362 to 660mm)	3 1/2" (89mm)

DIMENSIONS

ILB02

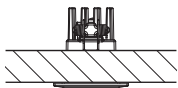

FRONT VIEW

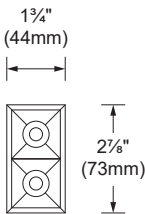

BOTTOM VIEW



Visual comfort UGR < 10.

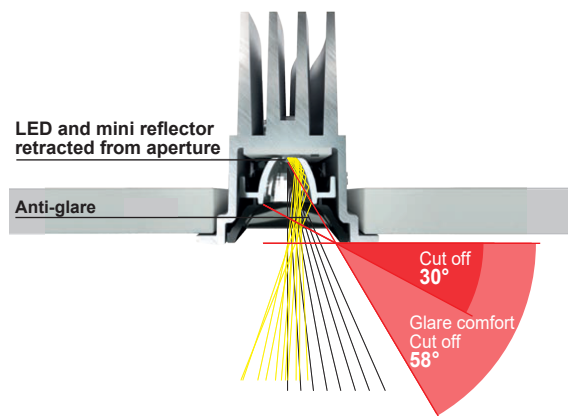

LED COLOR FIDELITY DATA

CRI	CCT	R1	R2	R3	R4	R5	R6	R7	R8	R9	R10	R11	R12	R13	R14	R15	Rf	Rg	Melanopic ratio
92	3000K	93	97	98	92	93	95	92	82	60	91	92	82	94	99	90	92	99	0.571
	3500K	92	95	96	92	91	93	93	83	59	87	92	79	93	97	89	92	99	0.635
	4000K	93	94	94	93	92	91	94	86	64	85	93	78	93	96	90	91	100	0.715

PHOTOMETRIC DATA

CCT (K)	CRI	LOAD (W)	OPTIC	LUMENS (lm)	EFFICACY (lm / W)	MAX CANDELA (cd)	MODELS
3000K	92	6.1W	Flood 32°	374	61	1 184	ILB02-030-FL

Use multiplier table for other CCT and CRI output data. Efficacy based on IESNA LM-79 test reports. Visit iguzzini.com/us for complete photometric data.

Flood 32° (3000K, 92CRI)

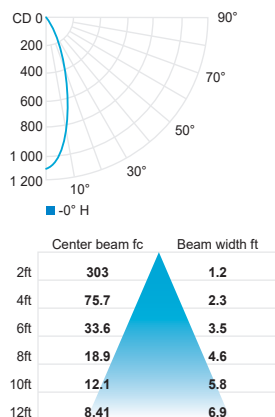

CCT options	3000K	3500K	4000K
CRI options	92CRI	92CRI	92CRI
Multiplier	1	1.05	1.09