

PALCO FAMILY LOW VOLTAGE (48V)

WARNING:

THE SAFETY OF THIS FIXTURE IS GUARANTEED ONLY IF YOU COMPLY WITH THESE INSTRUCTIONS; REMEMBER TO CONSERVE IN A SAFE PLACE.

ATTENTION:

LA SÉCURITÉ DE L'APPAREIL N'EST GARANTIE QU'EN CAS D'UTILISATION CORRECTE DES INSTRUCTIONS SUIVANTES; IL FAUT PAR CONSÉQUENT LES CONSERVER.

ATTENCION:

LA SEGURIDAD DEL APARATO SE GARANTIZA SOLO CUMPLIENDO CUIDADOSAMENTE LAS SIGUIENTES INSTRUCCIONES; ES NECESARIO CONSERVARLAS.

ATTENZIONE:

LA SICUREZZA DELL'APPARECCHIO E' GARANTITA SOLO CON L'USO APPROPRIATO DELLE SEGUENTI ISTRUZIONI; PERTANTO E' NECESSARIO CONSERVARE.

EN INSTALL IN ACCORDANCE WITH NATIONAL ELECTRIC CODE, LOCAL AND FEDERAL CODE SPECIFICATION.

FR VEUILLEZ INSTALLER CE PRODUIT EN CONFORMITÉ AVEC LE CODE ÉLECTRIQUE NATIONAL ET LES SPÉCIFICATIONS DU CODE LOCAL ET FÉDÉRAL.

ES INSTALAR EL PRODUCTO RESPETANDO LAS NORMAS ELÉCTRICAS NACIONALES Y LAS ESPECIFICACIONES DE LAS NORMAS LOCALES Y FEDERALES.

IT SI PREGA DI INSTALLARE QUESTO CONFORMITÀ CON IL NATIONAL ELECTRICAL CODE E LE SPECIFICHE DEL CODICE LOCALE E FEDERALE.

EN N.B.: WHEN INSTALLING THE SYSTEM, STRICTLY COMPLY WITH ALL REGULATIONS ON INSTALLATION IN FORCE.

FR N.B.: LORS DE L'INSTALLATION DU SYSTÈME VEILLER RESPECTER RIGOREUSEMENT LES NORMES EN VIGUEUR EN LA MATIÈRE.

ES N.B.: DURANTE LA INSTALACIÓN DEL SISTEMA RESPECTAR E SCRUPULOSAMENTE LAS NORMAS DE INSTALACIÓN VIGENTES.

IT N.B.: DURANTE L'INSTALLAZIONE DEL SISTEMA RISPETTARE SCRUPolosAMENTE LE NORME IMPIANTISTICHE VIGENTI.

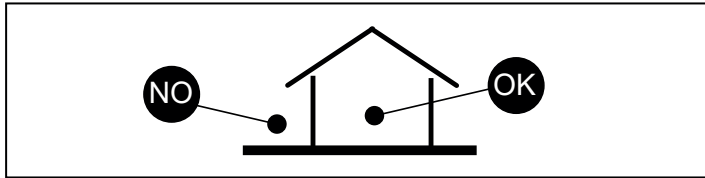
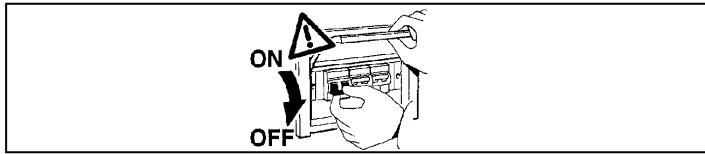

EN Correct product operation is only guaranteed if iGuzzini tracks and accessories are used.

FR Le fonctionnement des produits n'est garanti qu'en cas d'utilisation de rails et accessoires iGuzzini.

ES El funcionamiento de los productos se garantiza solamente si se utilizan railes y accesorios iGuzzini.

IT Il funzionamento dei prodotti è garantito solo con l'utilizzo di binari ed accessori iGuzzini.

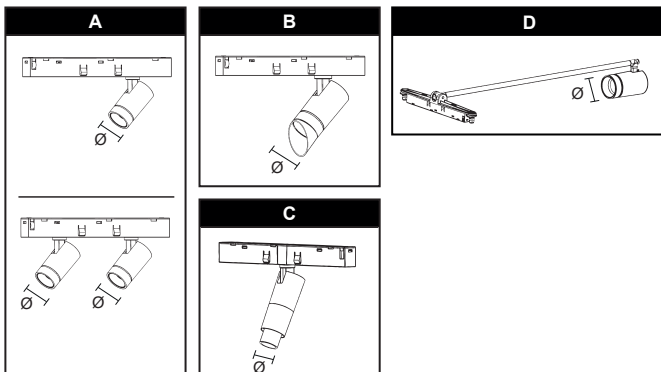

OPTICS	PRODUCT	Ø	ART
SPOT	SINGLE & DOUBLE A	¾" (19mm)	IPLC-LV1-19-XXX-SP IPLC-SR1-19-XXX-SP Q622 - Q624
		2 x ¾" (2 x 19mm)	IPLC-LV2-19-XXX-SP IPLC-SR2-19-XXX-SP Q626 - Q628
		1½" (37mm)	IPLC-LV1-37-XXX-SP IPLC-SR1-37-XXX-SP Q630 - Q633
		2" (51mm)	IPLC-LV1-51-XXX-SP IPLC-SR1-51-XXX-SP Q636 - Q639
MEDIUM	SIMPLE & DOUBLE A	¾" (19mm)	IPLC-LV1-19-XXX-MD IPLC-SR1-19-XXX-MD Q623 - Q625
		2 x ¾" (2 x 19mm)	IPLC-LV2-19-XXX-MD IPLC-SR2-19-XXX-MD Q627 - Q629
		1½" (37mm)	IPLC-LV1-37-XXX-MD IPLC-SR1-37-XXX-MD Q631 - Q634
	ON ROD D	¾" (19mm)	IPLC-LVR-19-XXX-MD Q642 - Q643
		1½" (37mm)	IPLC-LVR-37-XXX-MD Q644 - Q646
FLOOD	SIMPLE A	1½" (37mm)	IPLC-LV1-37-XXX-SP IPLC-SR1-37-XXX-SP Q637 - Q640
WIDE FLOOD	SIMPLE A	1½" (37mm)	IPLC-LV1-37-XXX-WF IPLC-SR1-37-XXX-WF Q632 - Q635
		¾" (19mm)	IPLC-LV1-19-XXX-WF IPLC-SR1-19-XXX-WF Q638 - Q641
	ON ROD D	1½" (37mm)	IPLC-LVR-37-XXX-WF Q645 - Q647
WALL WASHER	WALL WASHER B	1½" (37mm)	IPLC-LV1-37-XXX-WW IPLC-SR1-37-XXX-WW Q652 - Q653
SPOT WIDE FLOOD	BEAMER C	¾" (19mm)	IPLC-LV1-19-XXX-BE IPLC-SR1-19-XXX-BE QW43 - QW44 - QW45

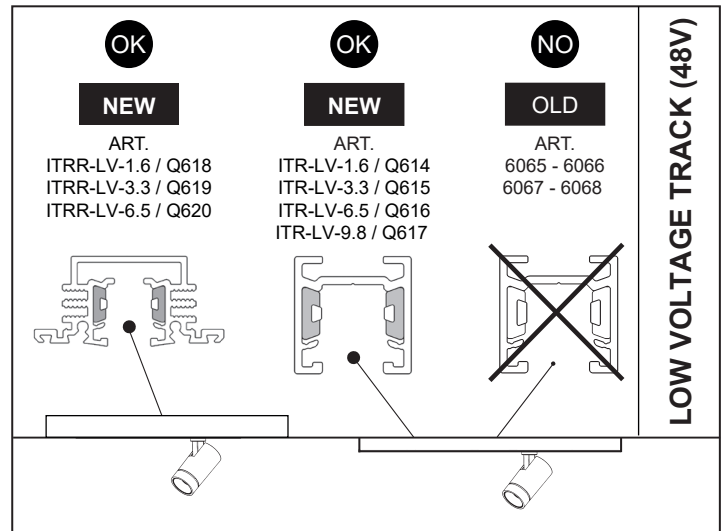

<div><div>A</div><div>C</div></div>	PB60		ITRD-SR-1.6 / QY73 ITRD-SR-3.3 / QY74 ITRD-SR-6.5 / QY75 ITRD-SR-9.8 / QY76	<div>OK</div>	SUPERRAIL
<div><div>B</div></div>	PB61				
<div><div>*A</div><div>*C</div></div>	PB60		ITRD-SR-1.6 / QY77 ITRD-SR-3.3 / QY78 ITRD-SR-6.5 / QY79 ITRD-SR-9.8 / QY80	<div>OK</div>	
<div><div>*B</div></div>	PB61				
* FOR USE DOWN SIDE ONLY					

FOR TRACK LV

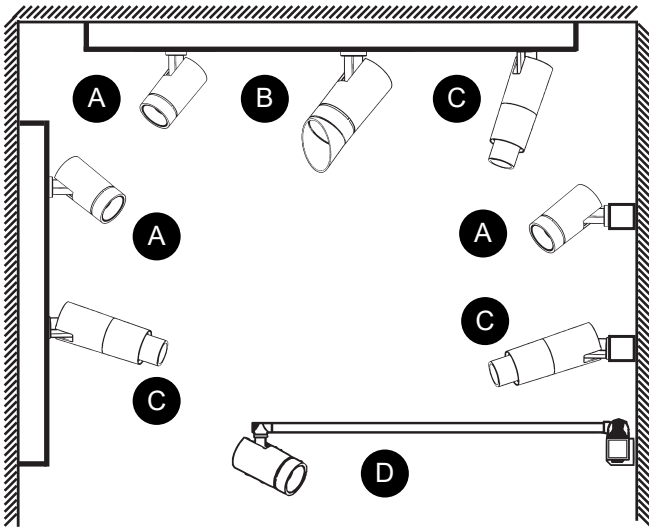

FOR SUPERRAIL

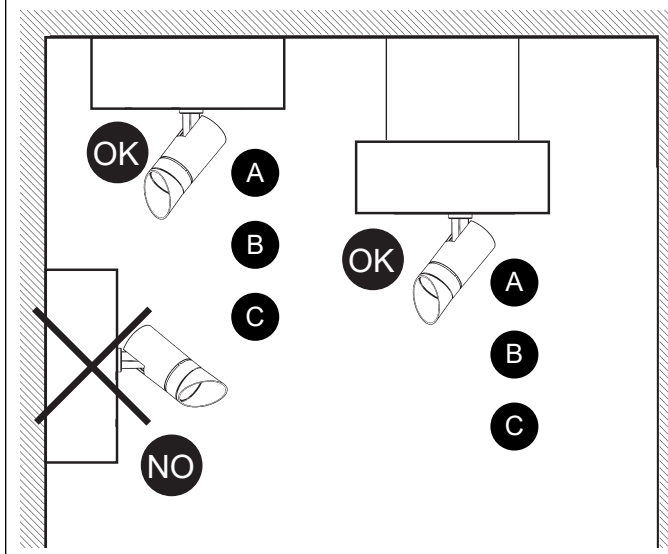

A - B - C FIXTURE INSTALLATION

FOR TRACK LV

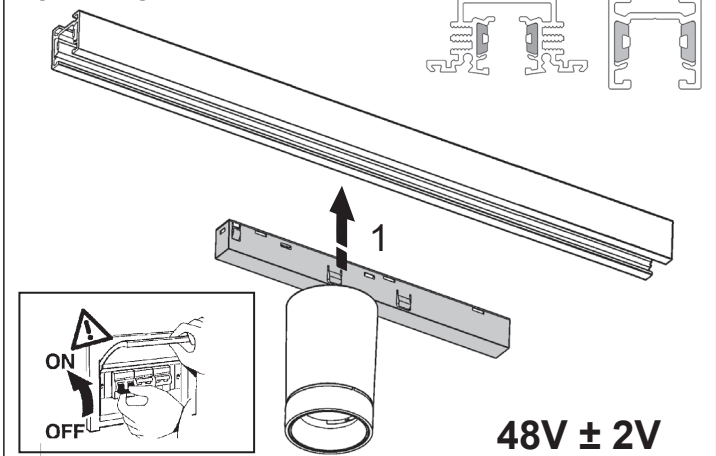

FOR SUPERRAIL, USE ADAPTER IPB60 OR IPB61. SEE INSTRUCTION FOR IPB60 AND IPB61

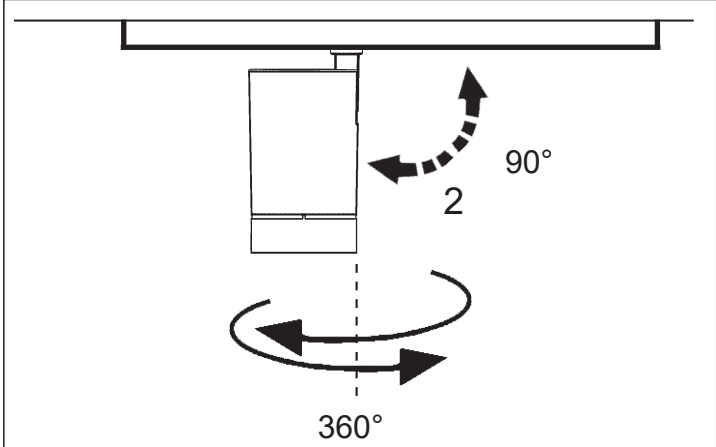

A - B - C FIXTURE REPOSITIONING

FOR TRACK LV

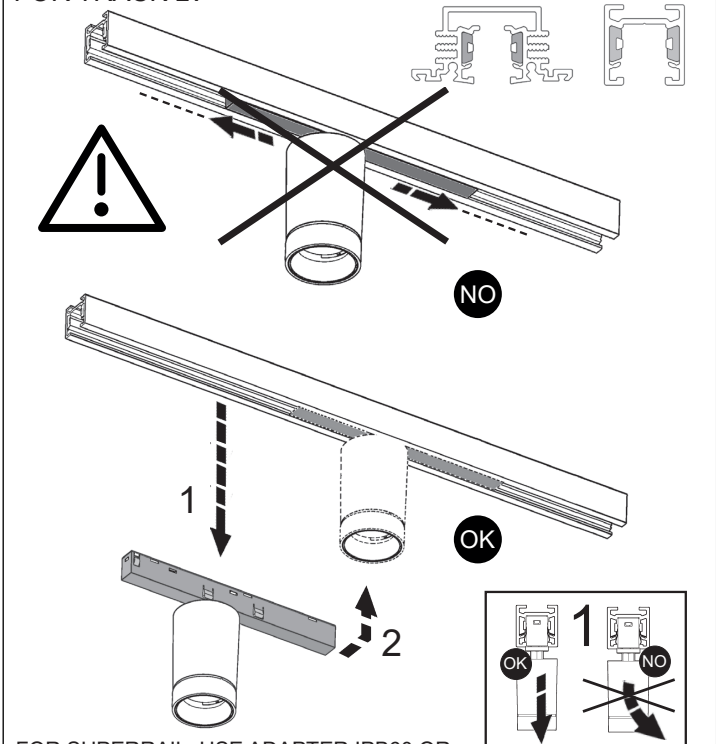

FOR SUPERRAIL, USE ADAPTER IPB60 OR IPB61. SEE INSTRUCTION FOR IPB60 AND IPB61

B WALL WASHER ADJUSTMENT

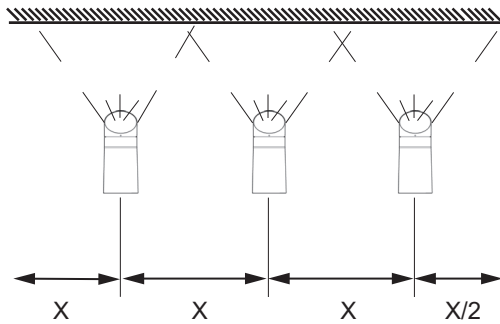
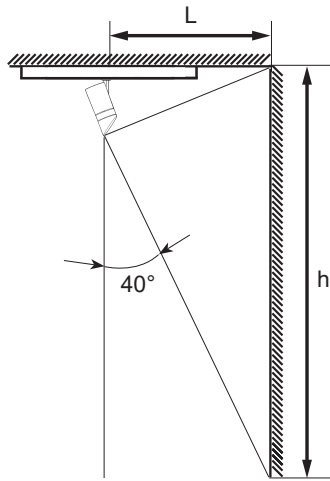

ART	L In (m)	X MAX In (m)	h In (m)
IPLC-LV1-51-XXX-WW Q652 - Q653	39" (1m)	27" (0.7m)	106" (2.7m)

C FOCUS ADJUSTMENT

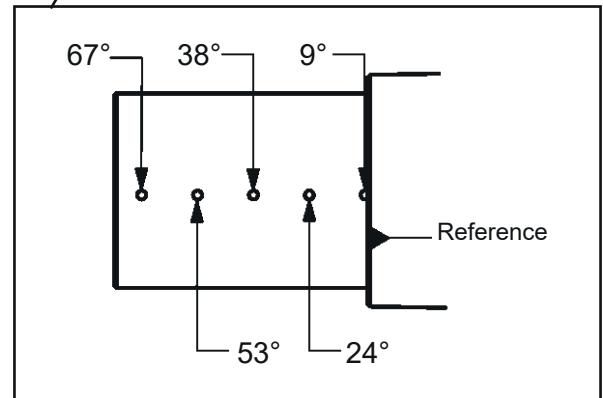
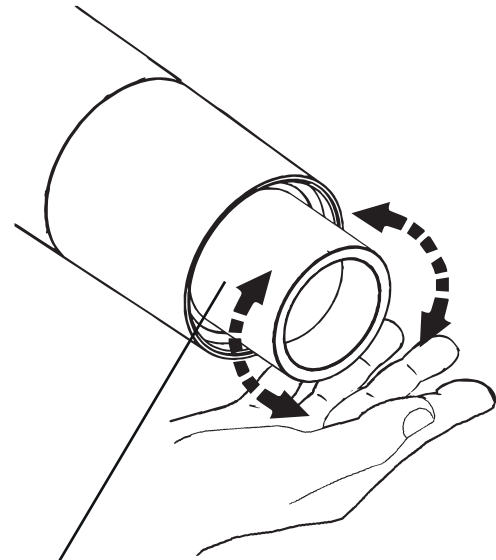

C ATTENTION

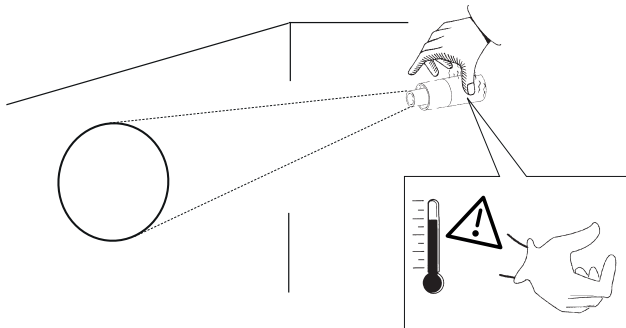

EN Only to be installed on tracks positioned outside the area required for access.

FR À installer uniquement sur rails posées hors du volume d'accessibilité.

ES Solo se debe instalar en raíles colocados fuera del área de accesibilidad.

IT Da installare solo su binari posti al di fuori del volume di accessibilità.

A - B - D ACCESSORIES

PRODUCT	Ø	Spill ring louver		Cylindrical screen		Honeycomb louver		Elliptical lens	
		IMZ49	IMZ52	IMZ48	IMZ51	IMZ43	IMZ45	IMZ47	IMZ50
A	¾" (19mm)	X	X	X	X	X	X	X	X
	1½" (37mm)	✓	X	✓	X	✓	X	✓	X
	2" (51mm)	X	✓	X	✓	X	✓	X	✓
B	2" (51mm)	✓	X	✓	X	✓	X	✓	X
D	¾" (19mm)	X	X	X	X	X	X	X	X
	1½" (37mm)	✓	X	✓	X	✓	X	✓	X

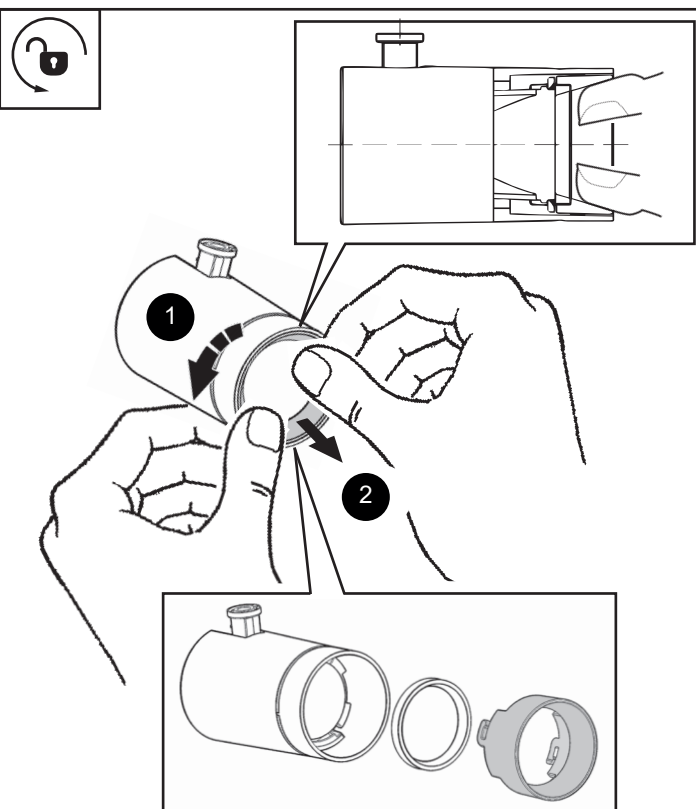

art.
IMZ49
IMZ52

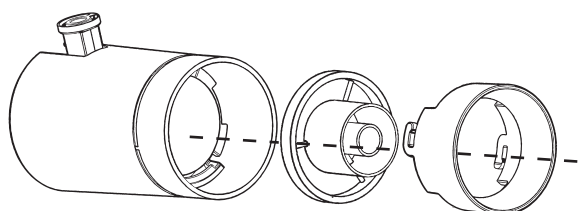
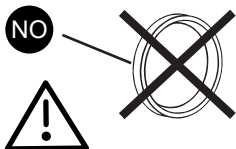

art.
IMZ43
IMZ45

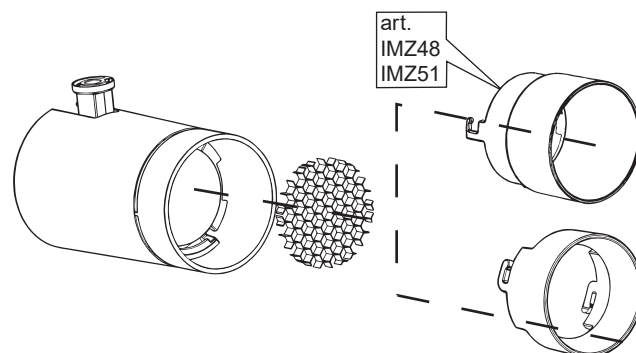
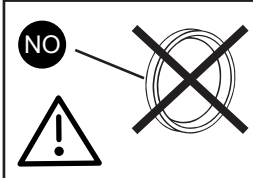

art.
IMZ48
IMZ51

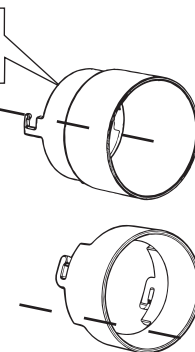

art.
IMZ48
IMZ51

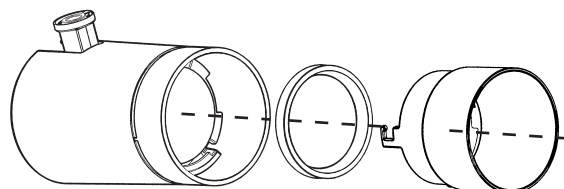
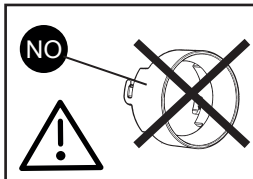
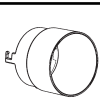

art.
IMZ47
IMZ50

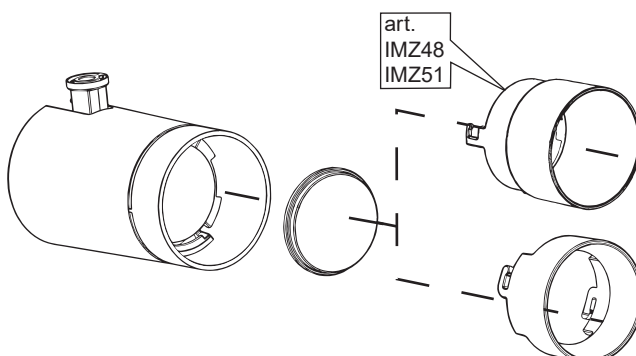
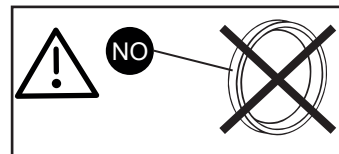

art.
IMZ48
IMZ51

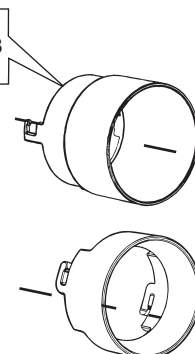

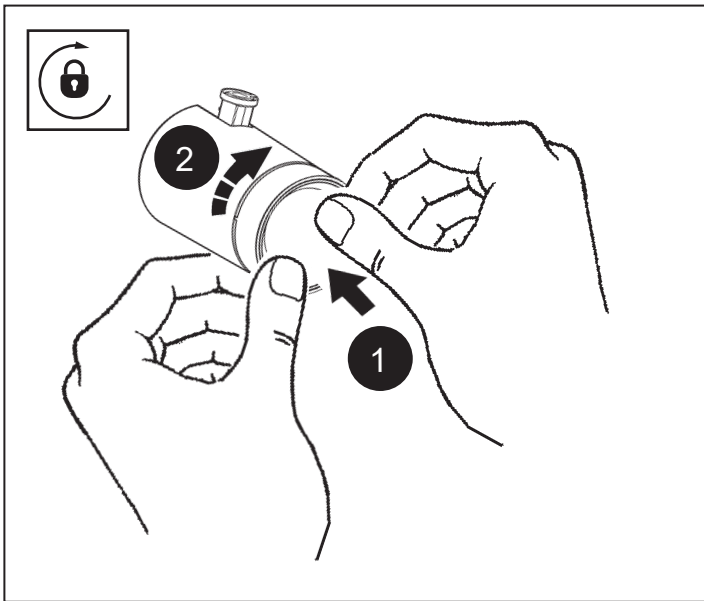

D INSTALLATION

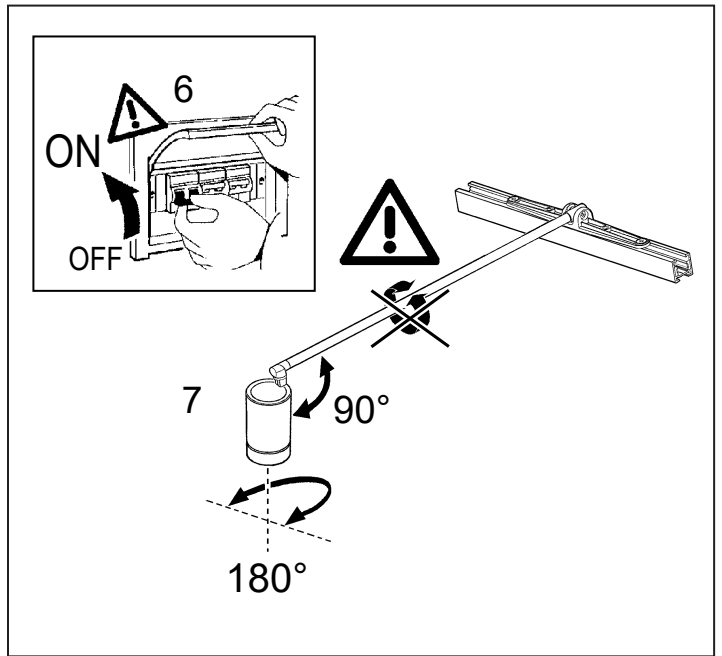
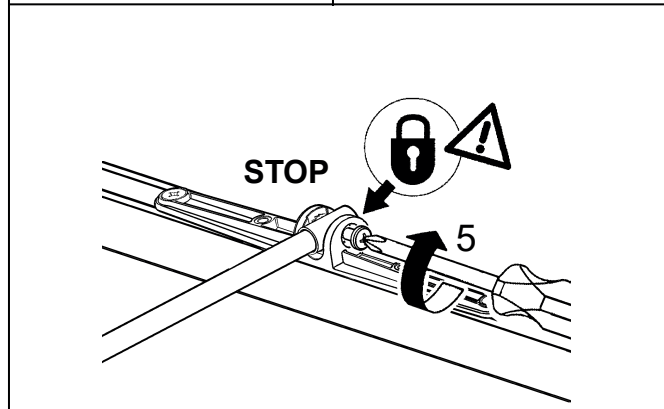
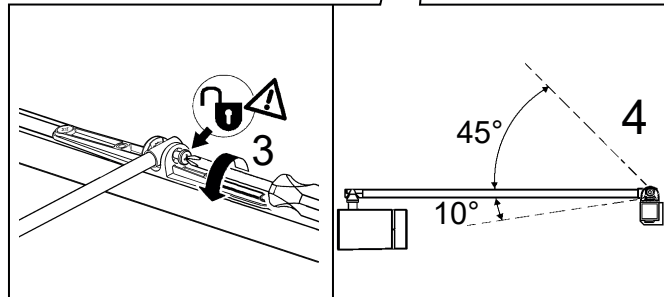
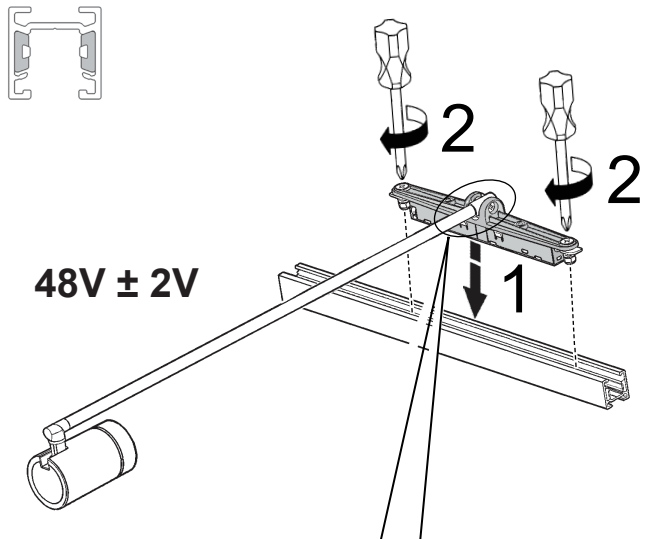

D CHANGE POSITION

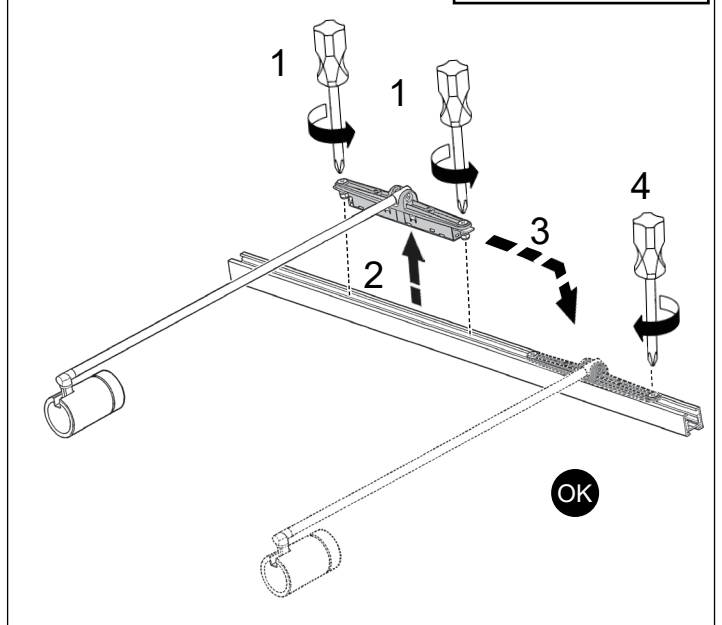
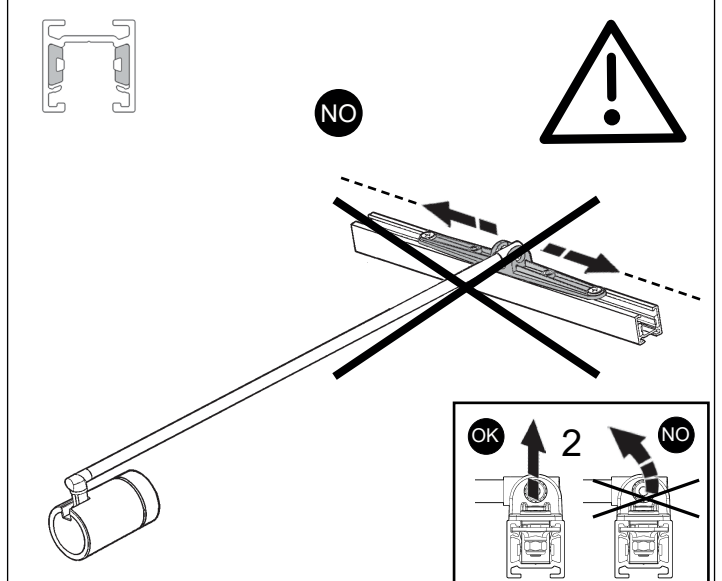

iGuzzini North America

9320 Boul.St-Laurent
suite 100, Montréal (Québec)
Canada H2N 1N7
P.: 514.523.1337
F.: 514.525.6107
www.iguzzini.com/us
DM - 03.03.2022

Headquarters iGuzzini illuminazione spa
via Mariano Guzzini, 37 - 62019 Recanati Italy