

[EN] - Instructions for use

Code LSS100100

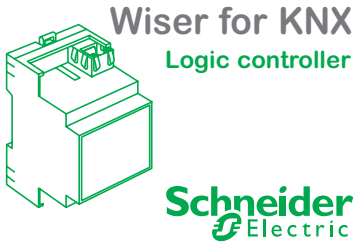

KNX/Modbus/BACnet/IP



Connections and operating elements

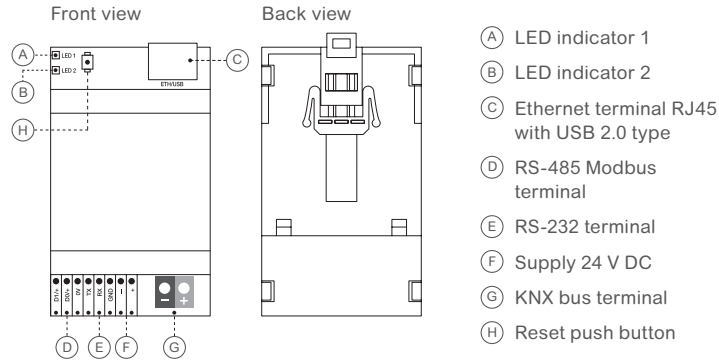

For your safety



**Danger**  
Risk of fatal injury due to electrical current.  
Any work on the device should only be carried out by qualified electricians. Please observe the country specific regulations as well as the relevant KNX guidelines.



**Danger**  
The Wiser for KNX must be supplied via a SELV and low power circuit (LPS) certified power supply, according to the IEC 60950-1.

Mounting the Wiser for KNX



**Warning**  
Risk of death from electric shock.  
Mishandling of the device may cause damage. Safety clearance must be adhered to in accordance with IEC 60664-1. There must be at least 4 mm between the individual cores of the 230 V supply cable and the KNX bus cable.

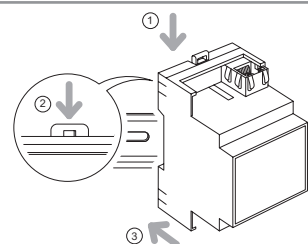
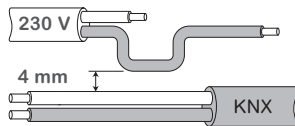

- 1 Place the device into the DIN rail (see picture)
- 2 Press down the DIN rail lock
- 3 Wire the device of the desired application accordingly and connect the power supply at the end

Getting to know

The Wiser for KNX is the easiest way to visualise and program complex logic in KNX and Modbus networks.

Applications:

- > Logical functions
- > WEB SCADA visualization for PC
- > Cross-standard gateway between KNX and Modbus RTU/TCP
- > BACnet Server
- > Integration with third party devices over RS-232 (IR, AV)
- > Scheduling
- > Camera streaming
- > Data logger with trends

Technical data

Supply voltage	24 V DC	Terminal	
Power consumption	2 W	KNX bus	Bus connecting terminal 2 x 0.8 mm
LED indicator 1	Green LED (CPU load)	Power supply	Clamp, 0.5 mm <sup>2</sup> –1.5 mm <sup>2</sup>
LED indicator 2	Green LED (Operation) or Red LED (Reset)	Serial	Clamp, 0.5 mm <sup>2</sup> –1.5 mm <sup>2</sup>
Interface	1x KNX 1x10BaseT/100BaseTX 1x RS-485 (incl. polarization resistors 47 kΩ, no termination) 1x RS-232 1x USB2.0 1x Reset push button	Operation	-5°C to +45°C
		Environment	Can be used at elevations up to 2000 m above sea level (MSL)
		Max. humidity	93%, no condensation
		Dimension (HxWxD)	90 x 52 x 58 mm

Network configuration

Default IP configuration

Login name:	admin
Password:	admin
IP address on LAN	192.168.0.10
Networks mask on LAN	255.255.255.0

Please read the Wiser for KNX product manual carefully for advice on how to configure and program the device properly. This product manual is available at Schneider Electric front office in your country.

Status LED

Procedure

Operating device	
Rebooting device	Press RESET < 10sec
Temporary settings of default IP	Press RESET > 10 sec To exit temporary settings Press RESET < 10 sec or Select system config -> System -> Reboot
Factory settings of default IP passwords & project deleted	Press RESET > 10 sec + Release + Press RESET > 10 sec

LED 1 status

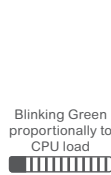

LED 2 status

